

SpitLight PIV Compact

Double Rail Series

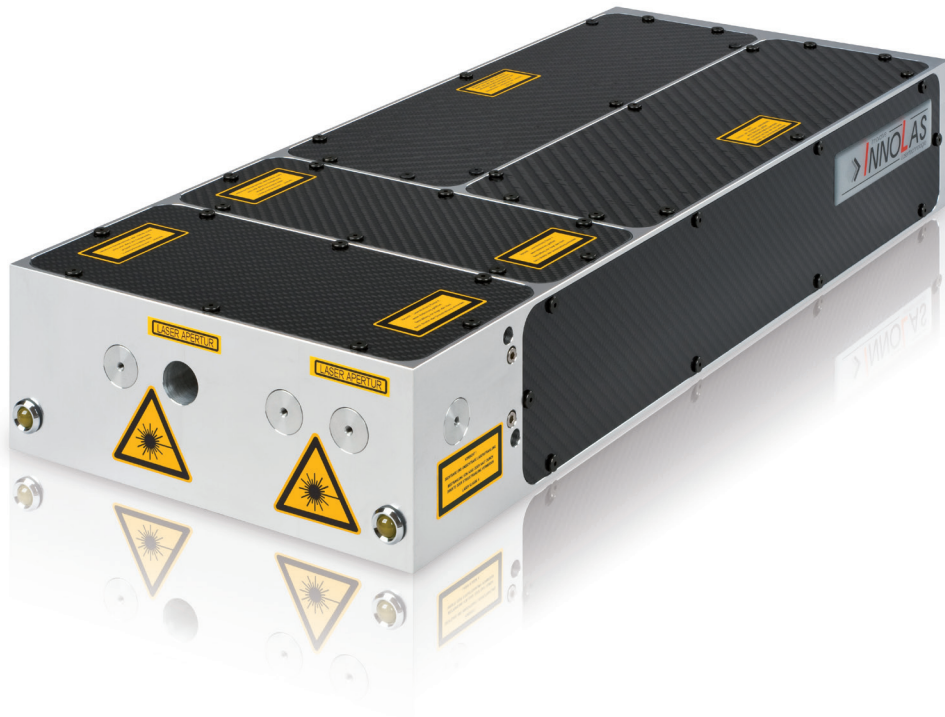

Features

- * Unlimited adjustable pulse separation
- * Compact laser head and power supply with small footprint
- * Robust and stable resonator structure
- * Quick and easy replacement of flashlamps
- * Maintenance-free pumping chamber with ceramic reflector
- * Excellent beam quality and pointing stability
- * Long flashlamp lifetime
- * Each cavity can be double pulsed
- * Quick connect laser head

SpitLight PIV Compact

Double Rail Series

Model		SpitLight PIV Compact 100	SpitLight PIV Compact 400	SpitLight PIV Compact DPSS
Laser Parameters	Repetition Rate	2 x 10 Hz	2 x 10 Hz	2 x 100 Hz
	Pulse Energy at 532 nm	> 2 x 60 mJ	> 2 x 180 mJ	> 2 x 50 mJ
Energy	Energy Stability at 532 nm (RMS)	< 1.3%	< 1.3%	< 1.0%
	Pulse Width at 532 nm	4-6 ns	4-6 ns	7-9 ns
Beam Parameters	Divergence	< 0.5 mrad (inst.)	< 0.5 mrad (inst.)	< 0.5 mrad (inst.)
	Pointing Stability	< ± 50 µrad	< ± 50 µrad	< ± 50 µrad
	Beam Diameter	4 mm	6 mm	5 mm
	Temporal Jitter	< ± 1 ns	< ± 1 ns	< ± 1 ns
	Warranted Pump Source Lifetime	> 20,000,000 shots	> 20,000,000 shots	2 years/2 billion shots*
Operating Parameters	Electrical Supply (two units)	each 208-240 VAC, 50/60 Hz, 1.5 kW	each 208-240 VAC, 50/60 Hz, 1.5 kW	each 208-240 VAC, 50/60 Hz, 1.5 kW
	Cooling Water	Water-to-Air	Water-to-Air	8 l/ min; 2-6 bar; < 15 °C
Weights	Laser Head	20 kg	20 kg	20 kg
	Power Supply (two units)	each 25 kg	each 25 kg	each 25 kg
Dimensions	Laser Head (in infrared) (L x W x H)	560 x 227 x 91 mm	585 x 227 x 91 mm	560 x 227 x 91 mm
	Power Supply (L x W x H)	each 480 x 220 x 480 mm	each 480 x 220 x 480 mm	each 480 x 220 x 480 mm

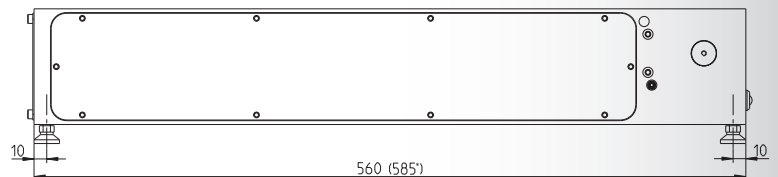
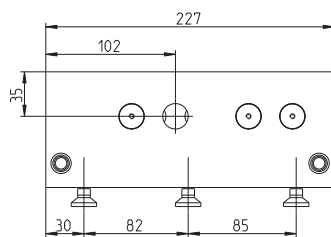

* Dimensions of SpitLight PIV Compact 400

InnoLas follows a policy of continuous product improvement. All specifications are subject to change without notice. All specifications at 1,064 nm unless otherwise noted. * 2 years after installation or 2 billion shots – whichever comes first

InnoLas Laser GmbH is DIN EN ISO 9001 certified.



InnoLas Laser GmbH | Justus-von-Liebig-Ring 8 | 82152 Krailling | Germany
Phone: +49 (89) 899 360 - 1400 | Fax: +49 (89) 899 360 - 1499
E-mail: info@innolas-laser.com | Homepage: www.innolas-laser.com



© InnoLas Laser GmbH 2015



Distributed by: Kenelec Scientific Pty Ltd | 1300 73 22 33 | sales@kenelec.com.au | www.kenelec.com.au