

## Spitlight DPSS DRY

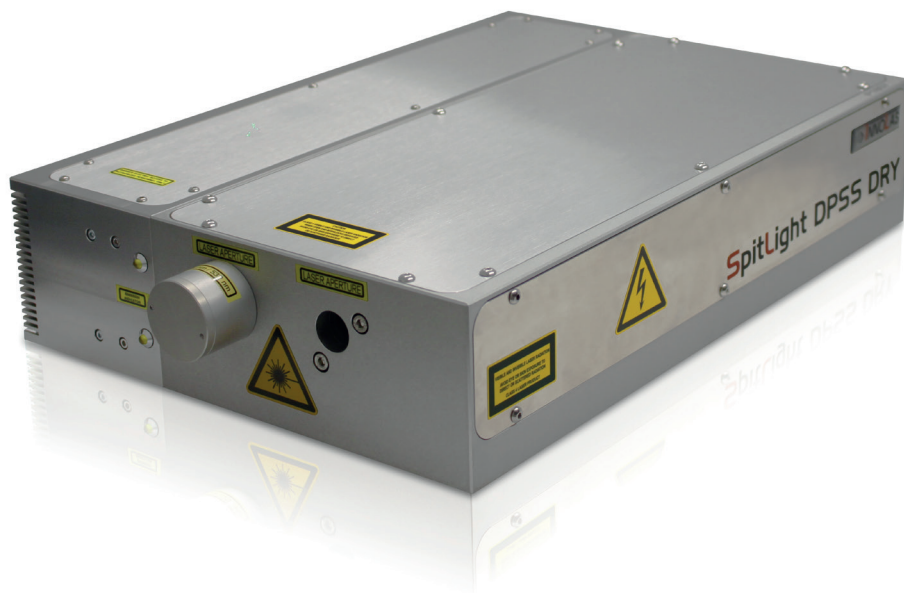

### Features

- \* No internal/external water cooling
- \* All-in-one: Integrated power supply
- \* Low voltage supply input
- \* Wide temperature range
- \* Robust and stable monolithic design
- \* Easy to integrate

## Spitlight DPSS DRY

Model	DPSS DRY S	DPSS DRY I	DPSS DRY II
Repetition rate	The following specifications are for 10 Hz		
<b>Pulse Energy [mJ]</b>			
Pulse Energy @ 1064 nm	> 10 mJ	> 80 mJ	> 150 mJ
Pulse Energy @ 532 nm	> 5 mJ	> 40 mJ	> 80 mJ
Pulse Energy @ 355 nm	> 2.5 mJ	> 20 mJ	> 50 mJ
Energy Stability @ 1064 nm (RMS)	< 1.0%	< 0.3%	< 0.3%
Energy Stability @ 532 nm (RMS)	< 1.5%	< 1.0%	< 0.8%
Energy Stability @ 355 nm (RMS)	< 2.5%	< 2.0%	< 1.5%
<b>Beam Parameters</b>			
Beam Diameter @ 1064 nm	1.0 mm	4.0 mm	5.5 mm
Divergence	< 0.5 mrad	< 0.5 mrad	< 0.5 mrad
Pointing Stability	< ± 30 µrad	< ± 20 µrad	< ± 20 µrad
M <sup>2</sup>	< 1.5	< 2	< 2
Pulse Duration @ 1064 nm	6-10 ns	6-10 ns	6-10 ns
Temporal Jitter	1 ns	1 ns	1 ns
<b>Operating Parameters</b>			
Warranted Diode Lifetime	2 years / 2 x 10 <sup>9</sup> shots*	2 years / 2 x 10 <sup>9</sup> shots*	2 years / 2 x 10 <sup>9</sup> shots*
Cooling System	Integrated peltier / air	Integrated peltier / air	Integrated peltier / air
Electrical Supply	208-240 VAC, 50/60 Hz, max 400 W	Integrated (20-36 V / max. 400 W)	Integrated (20-36 V / max. 400 W)

### Weights and Dimensions

Dimensions Laser Head (L x W x H)	285 x 135 x 68 mm (incl. two harmonics)	425 x 300 x 92 mm	425 x 300 x 92 mm
Weight Laser Head	7 kg	19 kg	19 kg
Size Power Supply	19", 1 RU	Integrated in laser head	Integrated in laser head

Drawing DRY I/II

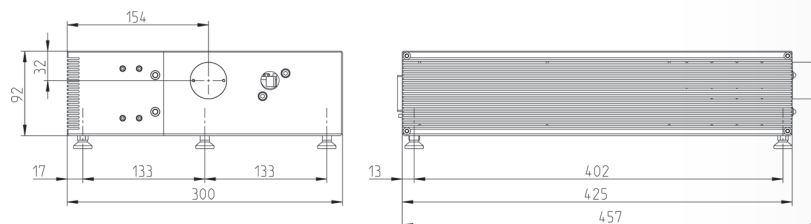

Drawing DRY S

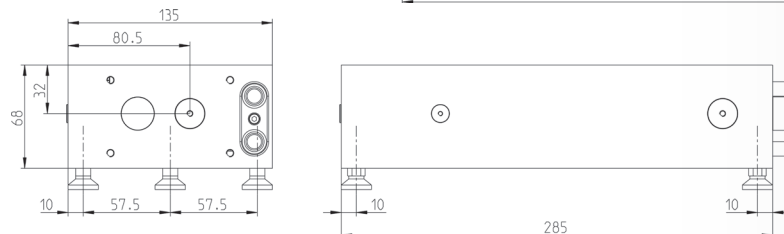

InnoLas follows a policy of continuous product improvement. All specifications are subject to change without notice.

\* 2 years after installation or 2 billion (2 x 10<sup>9</sup>) shots – whichever comes first

InnoLas Laser GmbH is DIN EN ISO 9001 certified.



**InnoLas Laser GmbH** | Justus-von-Liebig-Ring 8 | 82152 Krailling | Germany

Phone: +49 (89) 899 360 - 1400 | Fax: +49 (89) 899 360 - 1499

E-mail: [info@innolas-laser.com](mailto:info@innolas-laser.com) | Homepage: [www.innolas-laser.com](http://www.innolas-laser.com)



© InnoLas Laser GmbH 2019



Distributed by: Kenelec Scientific Pty Ltd | 1300 73 22 33 | [sales@kenelec.com.au](mailto:sales@kenelec.com.au) | [www.kenelec.com.au](http://www.kenelec.com.au)